

1. Bring specimen to room temperature before use. Remove QuPID® test device from foil pouch and identify as patient or control.
2. Holding the dropper vertically, add 2 drops of sample to round sample well.
3. Read result at 3 minutes.

IMPORTANT! Do not interpret result after 3 minutes.



NEGATIVE RESULT

The test is negative if only a line appears at the Control Zone (C) in the result area.



POSITIVE RESULT

The test is positive if two (2) colored lines appear. One (1) colored line will appear at the Specimen Zone (S) and one (1) at the Control Zone (C).

The appearance of any pink to red colored line in the Specimen Zone (S) along with a line in the Control Zone (C) should be considered positive. Intensity of colored lines is not an indication of the concentration of hCG in the sample.

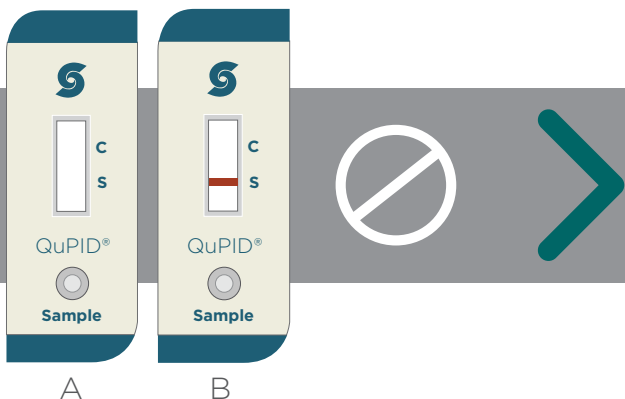

INVALID RESULT

- A) No lines appear
- B) Only specimen line appears.
(No control line appears)

> Repeat the test.